

# How to Login from Home to Access the Internet

These instructions are after you've connected to your home wireless network

1. Open (Web browser) and type in a website address URL into the address bar & click enter.
2. Tip: use google.com (it works better for this step).

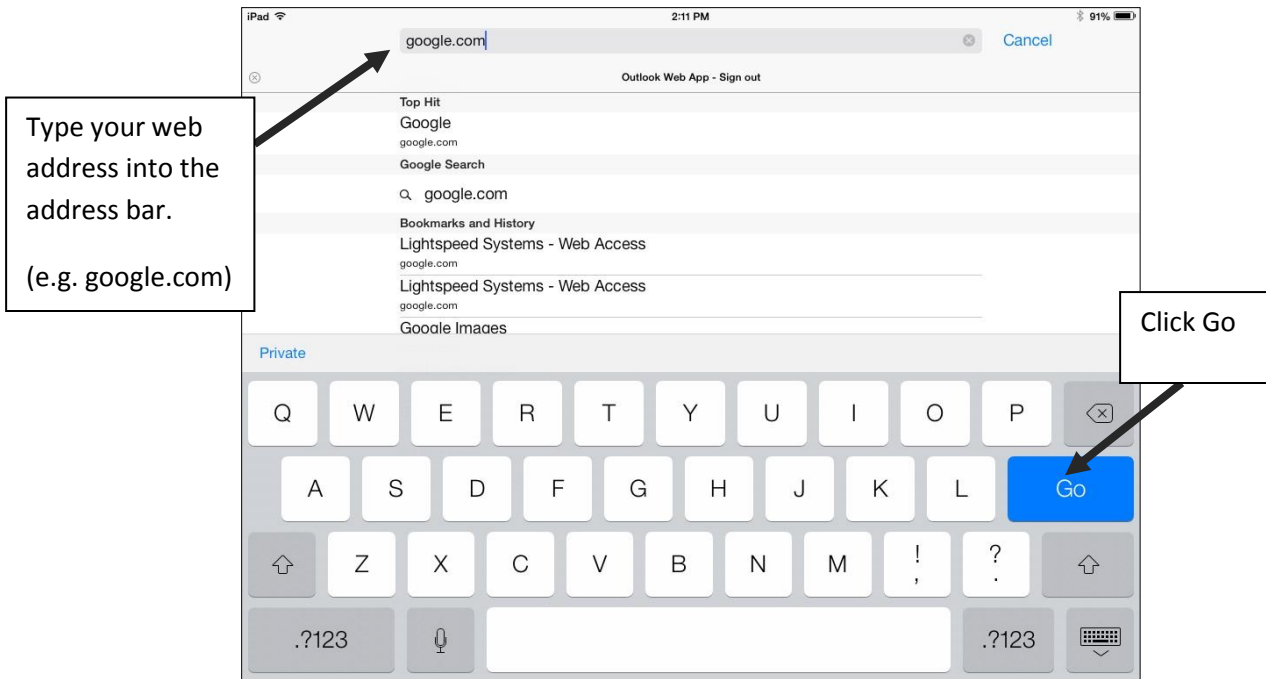

3. The first time you use your internet from home, you will see the following screen:

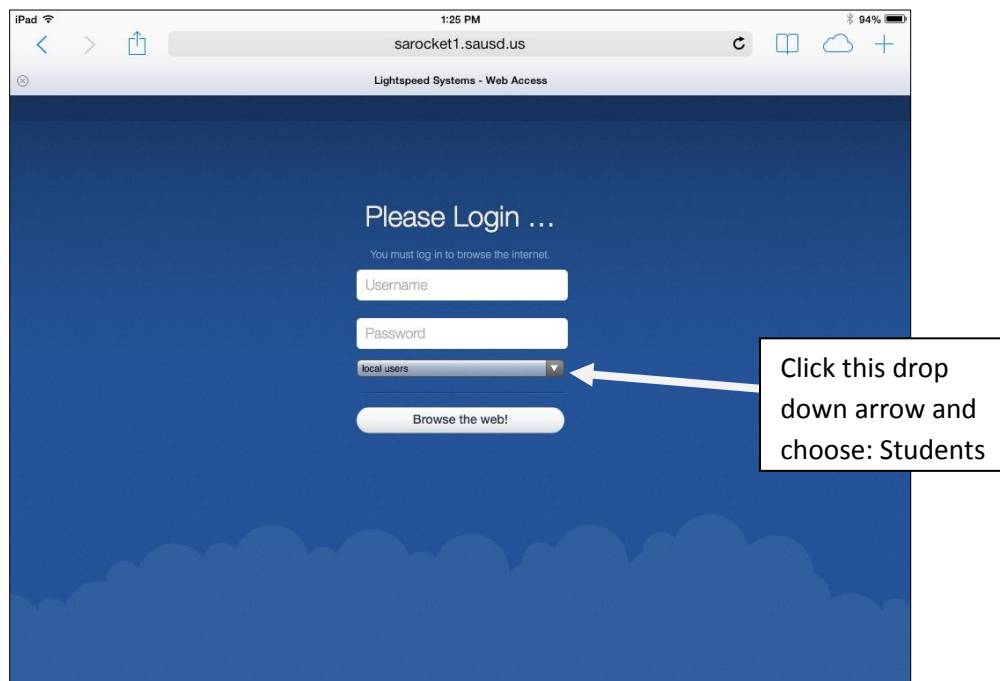

- Click the drop-down arrow, and choose: **Students**

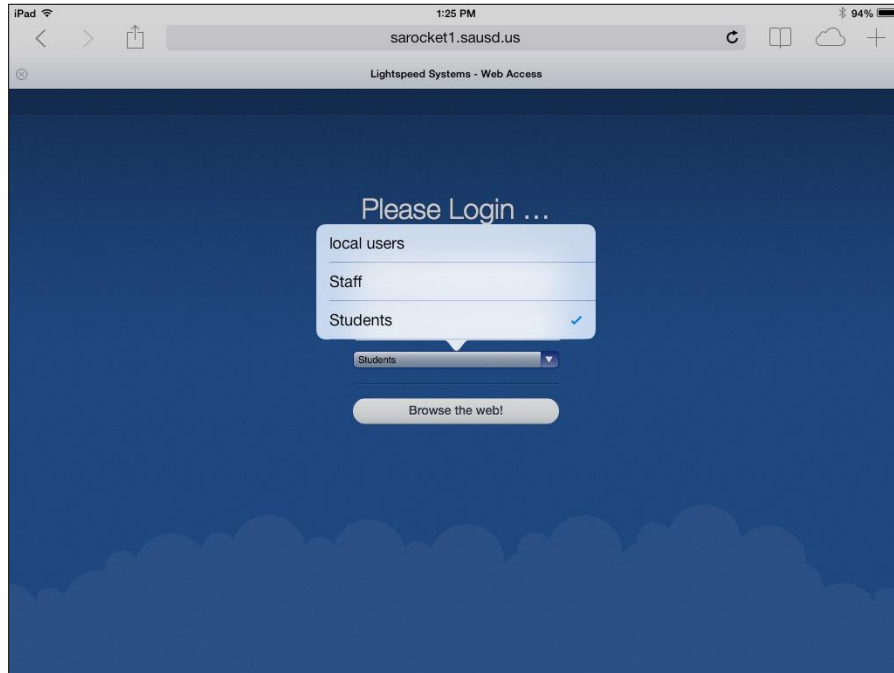

- Input your user name and password. The student's user name is their **6-digit Student ID# only**. The corresponding password is the student's Date of Birth (**mmddyyyy**). For example, if July 4, 2005 is your date of birth; then your password is 07042005

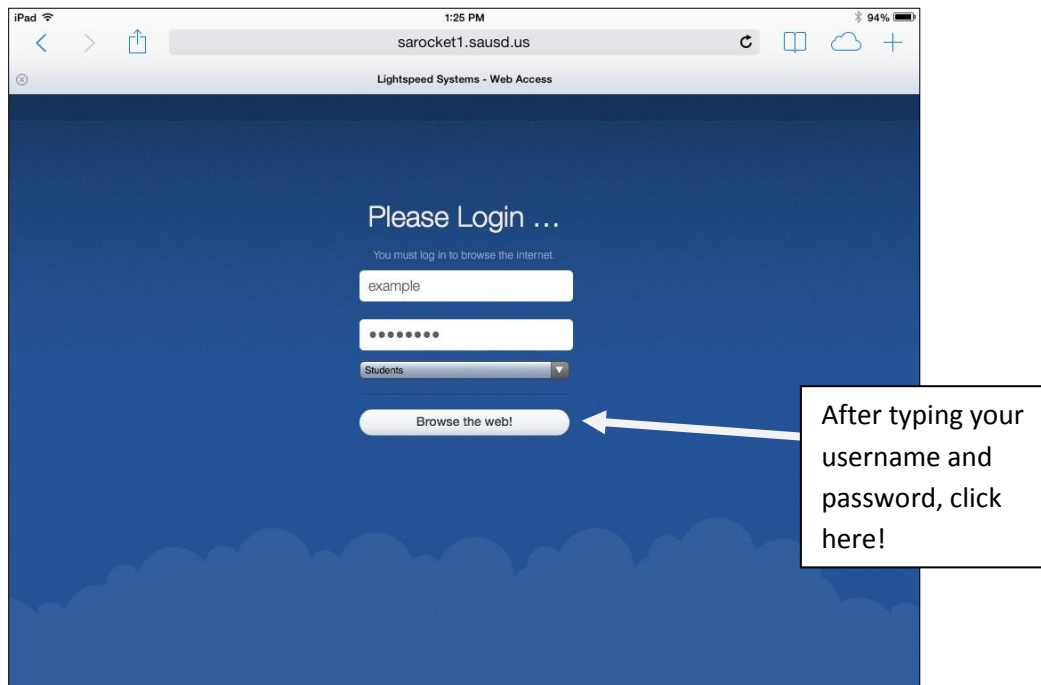

6. Click, "Browse the web" button and if you receive NO error message you're ready to browse the web.

After you have "logged in" type Google in the address bar to verify you can connect.

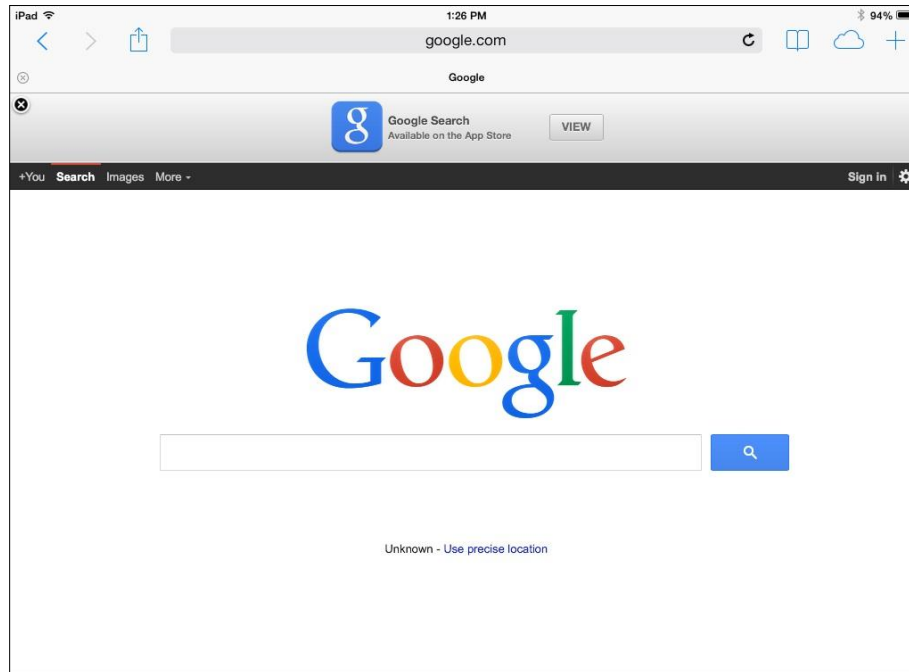

#### Notes:

-The login process above will open up internet access from home for 6 hours. After 6 hours has elapsed, the user must re-authenticate. The same login screen will pop-up again.

-Be sure to authenticate using the web browser before utilizing any apps, which may require the internet.

-This procedure works only if you have your own Internet service at home. In which case, be sure to connect to your home wireless network.